

Coaxial connectors type EIA

IEC 339, EIA RS-225



These quality connectors and additional supporting elements are the result of decades of experience. The whole range is designed to withstand severe environmental conditions. Precise manufacturing enables solid connections and low intermodulation (IMD) products.

The EIA family of coaxial connectors are available in 7/8", 1 5/8", 3 1/8", 4 1/2" and 6 1/8", all of which are suitable for RF applications. They support cables with foam dielectric and air-dielectric cables.

Connectors are delivered with an added inner conductor, and most are 'straight type' connectors. Supporting elements such as couplings, gas barriers and gas inlet valves are also available for a complete installation solution.

Technical Data

Coaxial connectors type EIA

Impedance	50 Ohm
Dielectric	PTFE
Body	CuZn
Contacts	CuBe, CuSn
Surface finish	Contacts - silver or gold plated Body - nickel or silver plated
Temperature range	from - 65°C to +165°C (Climate category according IEC 6855/155/56)

Dimensions of the coaxial lines

STANDARD		DIMENSIONS (mm)				fc (GHz) Z = 50 Ohms
339 IEC	EIA	A	B	C	D	
50-22	7/8"	22,23	19,95	8,70	7,40	6,68
50-40	1 5/8"	41,30	38,90	16,90	15,00	3,43
50-80	3 1/8"	79,40	76,90	33,40	31,30	1,73
50-105	4 1/2"	106,00	103,00	44,80	42,80	1,29
50-155	6 1/8"	156,00	152,00	66,04	64,01	0,87



ID Connecting connectors are suitable for all major cable manufacturers. Each type of connector suits designated cable type. difference is at foam cable 7/8". RFS produces this cable with larger inner diameter; therefore inner is rather different other suppliers. When ordering specify for which cable the connector is required.

The only
than from

These charts will help you find the product you are looking for.

EIA 7/8"	
RG 213/U RG 214/U	CEL 50-22-081
RG 177/U RG 218/U	CEL 50-22-071

	EIA 7/8"	EIA 1 5/8"	EIA 3 1/8"
Foam 1/2"	CEL 50-22-700 CEL 50-22-818	CEL 50-40-820	
Foam 7/8"	CEL 50-22-699 CEL 50-22-827 CEL 50-22-827/ RFS-JA	CEL 50-40-828 CEL 50-40-828/ RFS-JA	
Foam 1 5/8"	CEL 50-22-835	CEL 50-40-836	CEL 50-80-803

	EIA 7/8"	EIA 1 5/8"	EIA 3 1/8"	EIA 4 1/2"	EIA 6 1/8"
Air 3/8"	CEL 50-22-696 CEL 50-22-697 CEL 50-22-698				
Air 5/8"	CEL 50-22-687				
Air 7/8"	CEL 50-22-677	CEL 50-40-678			
Air 1 1/8"	CEL 50-22-667	CEL 50-40-668			
Air 1 5/8"	CEL 50-22-657	CEL 50-40-658	CEL 50-80-659		
Air 3 1/8"		CEL 50-40-641	CEL 50-80-643	CEL 50-105-643	
Air 4 1/8"			CEL 50-80-701	CEL 50-105-704	CEL 50-155-703
Air 5"					CEL 50-155-709
Air 6 1/8"					CEL 50-155-712

Short Coupling Elements With Gaskets And Screws

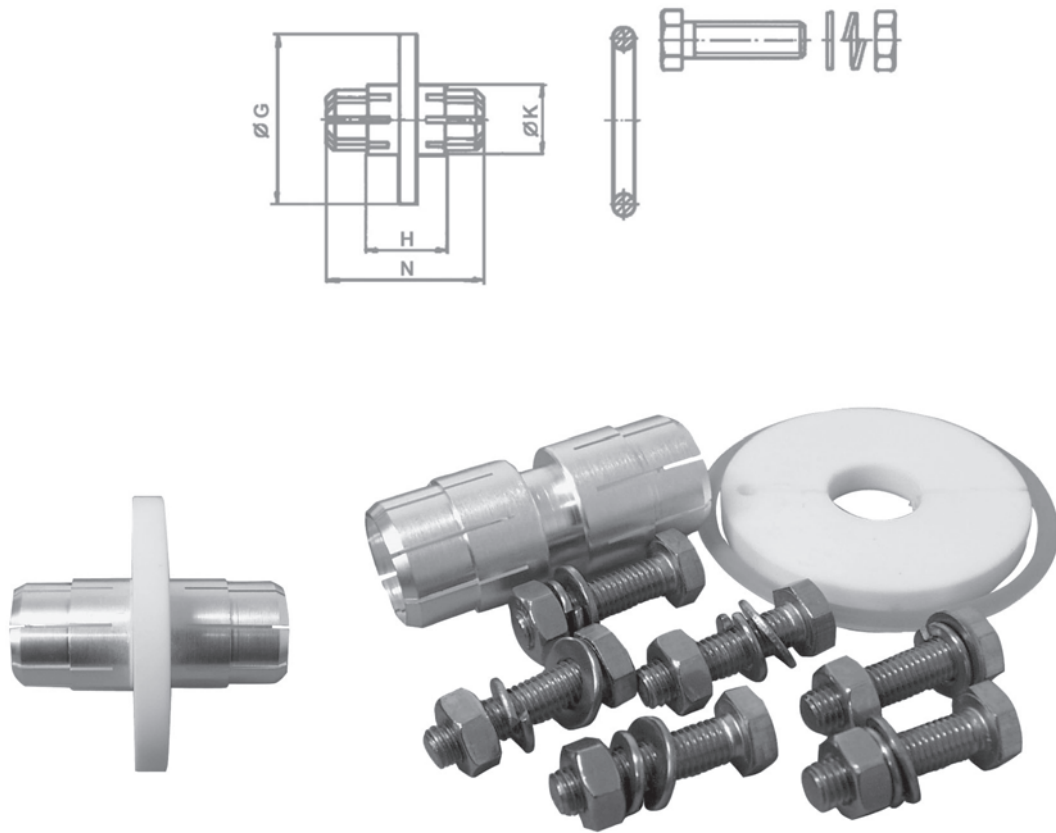

CEL 50-80-620

STANDARD		TYPE	CODE	DIMENSIONS (mm)				FLANGE SCREWS		GASKETS	
339 IEC	EIA			G	H	K	N	No.	screw	L	
50-22	7/8"	CEL 50-22-616	64521	20,7	23,9	8,66	49	3	M6	30	27 x 3,2
50-40	1 5/8"	CEL 50-40-618	64531	41,8	28,5	16,9	58	4	M8	35	47 x 5,4
50-80	3 1/8"	CEL 50-80-620	64533	81,3	45,0	33,4	80	6	M10	40	85 x 5,4
50-105	4 1/2"	CEL 50-105-622	64535	105,5	45,0	44,8	80	8	M10	45	110 x 6,0
50-125	5"	CEL 50-125-623	53968	124	46	52	120	8	M10	45	128X6
50-155	6 1/8"	CEL 50-155-624	65384	154,0	63,0	66,0	108	12	M10	60	159 x 7,0

Gas Inlet Valves

CODE 65531



CODE 65532



CODE 68220



CODE 70032



Panel Connectors

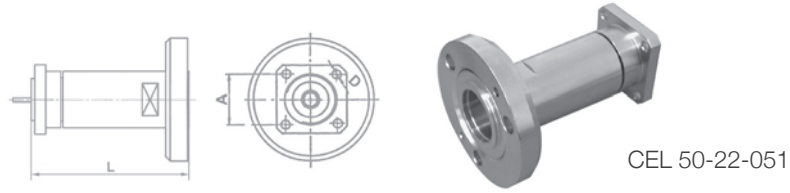

CEL 50-22-051

STANDARD	EIA	TYPE	CODE	DIMENSIONS (mm)		
339 IEC	7/8"	CEL 50-22-051	82182	A	D	L
50-22	7/8"	CEL 50-22-051	82182	24,75	3,60	81,00
50-40	1 5/8"	CEL 50-40-052	82183	45,20	4,80	75,00

In-Series T Adapter

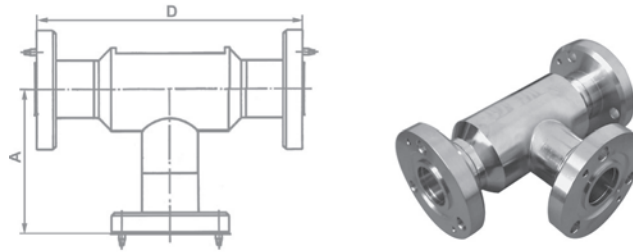

STANDARD	EIA	TYPE	CODE	DIMENSIONS (mm)	
339 IEC	7/8"	CEL 50-22-076	19973	A	L
50-22	7/8"	CEL 50-22-076	19973	63	140

Elbows

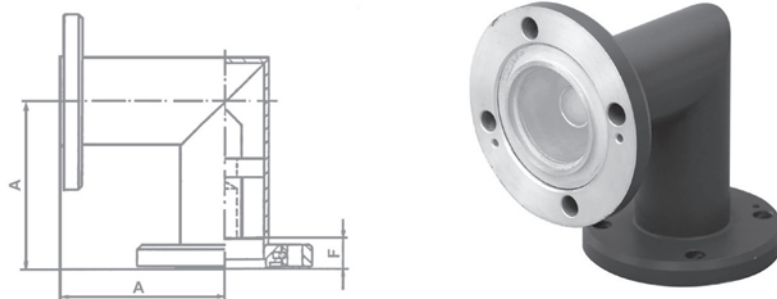

CEL 50-40-957

STANDARD	EIA	FIXED FLANGES		DIMENSIONS (mm)	
339 IEC	7/8"	TYPE	CODE	A	F
50-22	7/8"	CEL 50-22-949	64578	58	12,7
50-40	1 5/8"	CEL 50-40-957	92492	84	15,8
50-80	3 1/8"	CEL 50-80-967	92572	100	23,8
50-105	4 1/2"	CEL 50-105-972	53199	125	23,8
50-125	5"	CEL 50-125-979	59293	120	23,5
50-155	6 1/8"	CEL 50-155-976	95200	150	32,5

Multipoint Adapters

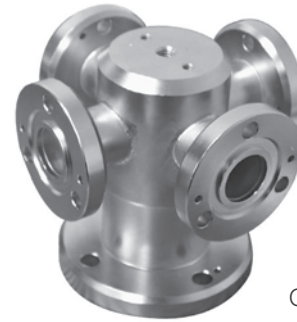
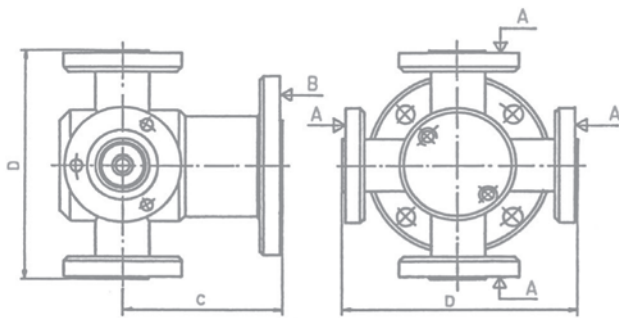

CEL 50-22-40-563

STANDARD		TYPE	CODE	DIMENSIONS (mm)	
A	B			C	D
2 x EIA 7/8"	EIA 7/8"	CEL 50-22-943	83266	65	110
3 x EIA 7/8"	EIA 7/8"	CEL 50-22-944	83267	65	110
4 x EIA 7/8"	EIA 7/8"	CEL 50-22-945	83268	65	110
2 x EIA 7/8"	EIA 1 5/8"	CEL 50-22-40-561	83425	75	110
3 x EIA 7/8"	EIA 1 5/8"	CEL 50-22-40-562	83426	75	110
4 x EIA 7/8"	EIA 1 5/8"	CEL 50-22-40-563	83427	75	110
2 x EIA 1 5/8"	EIA 1 5/8"	CEL 50-40-942	92162	65	130
2 x EIA 1 5/8"	EIA 3 1/8"	CEL 50-40-80-565	79883	75	150
3 x EIA 1 5/8"	EIA 3 1/8"	CEL 50-40-80-566	83428	75	150
4 x EIA 1 5/8"	EIA 3 1/8"	CEL 50-40-80-567	83430	75	150
2 x EIA 3 1/8"	EIA 6 1/8"	CEL 50-80-155-573	95201	on request	
3 x EIA 3 1/8"	EIA 6 1/8"	CEL 50-80-155-574	95202	on request	
4 x EIA 3 1/8"	EIA 6 1/8"	CEL 50-80-155-575	95203	on request	

Cable connectors

Cable Connectors, Clamp, 339 IEC 50-22 (EIA 7/8")

TYPE	CEL 50-22-081
CODE	60326
WEIGHT	307 g
CABLE TYPE	RG 213/U, RG 214/U
REMARK	Inner conductor mounted, combination system

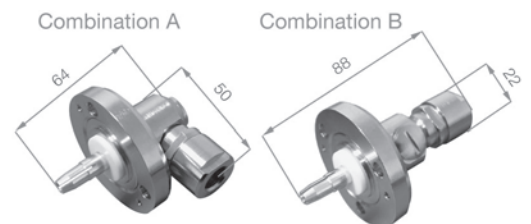
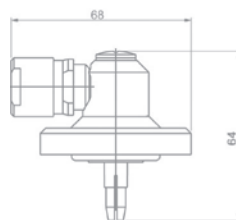

TYPE	CEL 50-22-699
CODE	52354
WEIGHT	456 g
CABLE TYPE	RFF 1/2"-50, CELLFLEX SCF 12-50
REMARK	Inner conductor added

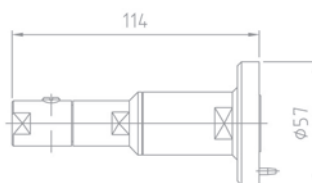

TYPE	CEL 50-22-071
CODE	60157
WEIGHT	523 g
CABLE TYPE	RG 177/U, RG 218/U
REMARK	Inner conductor added

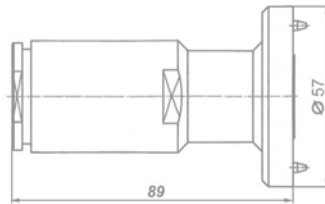

TYPE	CEL 50-22-700
CODE	59200
WEIGHT	382 g
CABLE TYPE	CELLFLEX LCF 12-50, HELIAX LDF4-50A, RF 1/2"-50, SUCOFEEED 1/2", EUPEN - 5128
REMARK	Inner conductor added

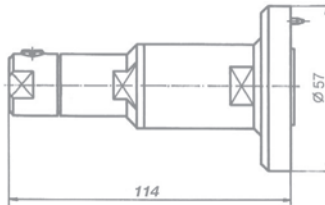

TYPE	CEL 50-22-818
CODE	64513
WEIGHT	444 g
CABLE TYPE	CELLFLEX LCF 12-50, HELIAX LDF4-50A, RF 1/2"-50, SUCOFEEED 1/2", EUPEN - 5128
REMARK	Inner conductor mounted. Right angle connector.

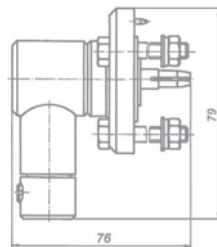

TYPE 1	CEL 50-22-827 and
CODE 1	66328
TYPE 2	CEL 50-22-827/RFS-JA
CODE 2	66333
WEIGHT	445 g
CABLE TYPE	CEL 50-22-827 for cables HELIAX LDF5-50A, RF 7/8"-50, SUCOFEEED 7/8", EUPEN - 5228. CEL 50-22-827/RFS-JA only for CELLFLEX LCF 78-50
REMARK	Inner conductor added See explanation on page 139

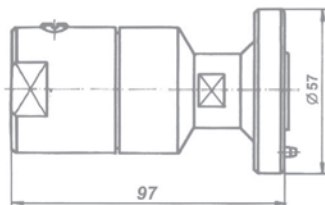

TYPE	CEL 50-22-835
CODE	68278
WEIGHT	2.135 g
CABLE TYPE	CELLFLEX LCF 158-50, RF 1 5/8"-50, SUCOFEEED 1 5/8" EUPEN - 5438
REMARK	Inner conductor added

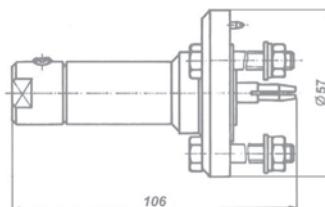
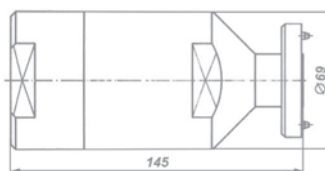

TYPE CEL 50-22-697
CODE 64943
WEIGHT 398 g
CABLE TYPE HELIFLEX HCA 38-50
REMARK Inner conductor added

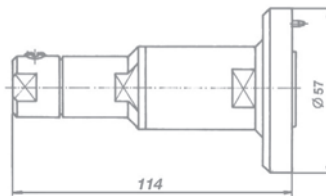

TYPE CEL 50-22-698
CODE 99677
WEIGHT 456 g
CABLE TYPE HELIFLEX HCA 38-50
REMARK Inner conductor mounted.
Right angle connector.

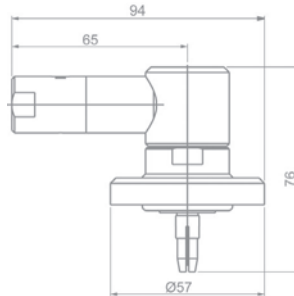

TYPE CEL 50-22-687
CODE 64645
WEIGHT 557 g
CABLE TYPE HELIFLEX HCA 58-50, HELIAX HJ4.5-50
REMARK Inner conductor added.
Connector with gas barrier and gas inlet valve M10 x 0,75

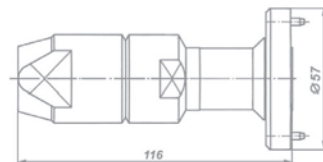

TYPE CEL 50-22-677
CODE 64643
WEIGHT 811 g
CABLE TYPE HELIFLEX HCA 78-50, HELIAX HJ5-50
REMARK Inner conductor added.
Connector with gas barrier and gas inlet valve M10 x 0,75

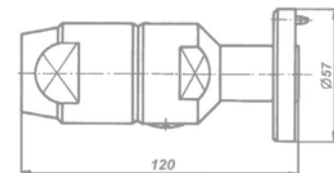

TYPE CEL 50-22-667
CODE 84469
WEIGHT 1.622 g
CABLE TYPE HELIFLEX HCA 118-50
REMARK Inner conductor added.
Connector with gas barrier and gas inlet valve M12 x 1,5

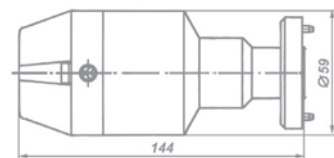

TYPE CEL 50-22-657
CODE 64358
WEIGHT 2.210 g
CABLE TYPE HELIFLEX HCA 158-50
REMARK Inner conductor added.
Connector with gas barrier and gas inlet valve M12 x 1,5

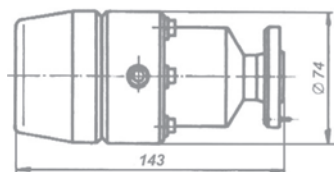

Cable Connectors, Clamp, 339 IEC 50-40 (EIA 1 5/8")

TYPE	CEL 50-40-820
CODE	76810
WEIGHT	1.110 g
CABLE TYPE	CELLFLEX LCF 12-50, HELIAX LDF4-50A, RF 1/2"-50, SUCOFEEED 1/2", EUPEN - 5128
REMARK	Inner conductor added

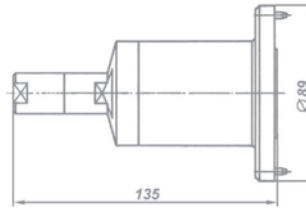

TYPE 1	CEL 50-40-828 and
CODE 1	66331
TYPE 2	CEL 50-40-828/RFS-JA
CODE 2	66336
WEIGHT	868 g
CABLE TYPE	CEL 50-40-828 for cables HELIAX LDF5-50A, RF 7/8"-50, SUCOFEEED 7/8", EUPEN - 5228. CEL 50-40-828/RFS-JA only for CELLFLEX LCF 78-50
REMARK	Inner conductor added See explanation on page 139

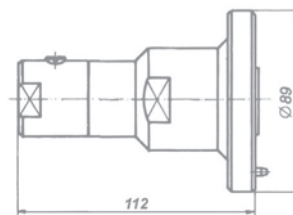

TYPE	CEL 50-40-836
CODE	67301
WEIGHT	2.227 g
CABLE TYPE	CELLFLEX LCF 158-50, RF 1 5/8"-50, SUCOFEEED 1 5/8", EUPEN - 5438, AVA6-50
REMARK	Inner conductor added

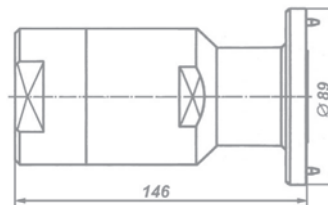

TYPE	CEL 50-40-678
CODE	66330
WEIGHT	1.250 g
CABLE TYPE	HELIFLEX HCA 78-50, HELIAX HJ5-50
REMARK	Inner conductor added. Connector with gas barrier and gas inlet valve M10 x 0,75

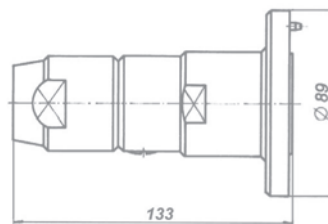

TYPE	CEL 50-40-668
CODE	64941
WEIGHT	2.200 g
CABLE TYPE	HELIFLEX HCA 118-50
REMARK	Inner conductor added. Connector with gas barrier and gas inlet valve M12 x 1,5

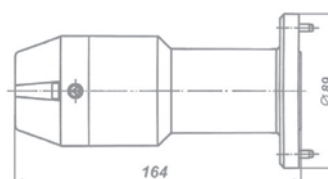

TYPE	CEL 50-40-658
CODE	64203
WEIGHT	2.477 g
CABLE TYPE	HELIFLEX HCA 158-50
REMARK	Inner conductor added. Connector with gas barrier and gas inlet valve M12 x 1,5

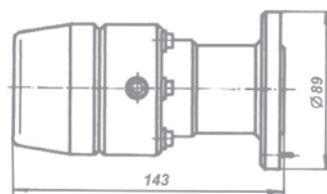

TYPE	CEL 50-40-641
CODE	72677
WEIGHT	7.500 g
CABLE TYPE	HELIFLEX HCA 400-50
REMARK	Inner conductor added. Connector with gas barrier and gas inlet valve M12 x 1,5

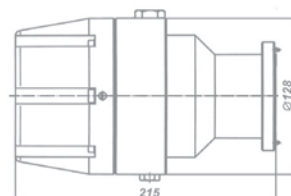

Cable Connectors, Clamp, 339 IEC 50-80 (EIA 3 1/8")

TYPE	CEL 50-80-659
CODE	66244
WEIGHT	3.670 g
CABLE TYPE	HELIFLEX HCA 158-50
REMARK	Inner conductor added. Connector with gas barrier and gas inlet valve M12 x 1,5

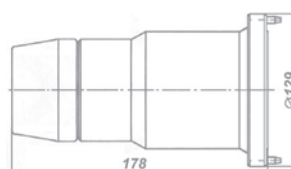

TYPE	CEL 50-80-643
CODE	46511
WEIGHT	9.600 g
CABLE TYPE	HELIFLEX HCA 400-50
REMARK	Inner conductor added. Connector with gas barrier and gas inlet valve M12 x 1,5

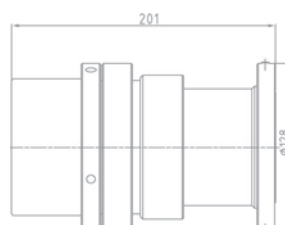

TYPE	CEL 50-80-701
CODE	72477
WEIGHT	14.100 g
CABLE TYPE	HELIFLEX HCA 495-50
REMARK	Inner conductor added. Connector with gas barrier and gas inlet valves M12 x 1,5 and M18 x 1,5

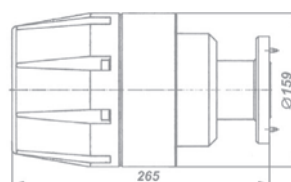

TYPE	CEL 50-80-803
CODE	48223
WEIGHT	3.600 g
CABLE TYPE	CELLFLEX LCF 158-50
REMARK	Inner conductor added

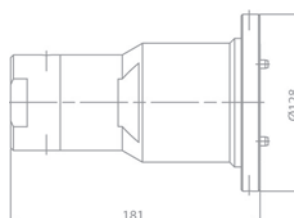

Cable Connectors, Clamp, 339 IEC 50-105 (EIA 4 1/2")

TYPE	CEL 50-105-643
CODE	98287
WEIGHT	11.000 g
CABLE TYPE	HELIFLEX HCA 400-50
REMARK	Inner conductor added. Connector with gas barrier and gas inlet valves M12 x 1,5

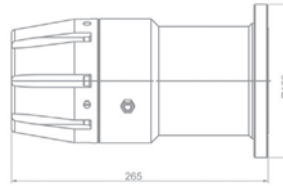

TYPE	CEL 50-105-704
CODE	46500
WEIGHT	14.600 g
CABLE TYPE	HELIFLEX HCA 495-50
REMARK	Inner conductor added. Connector with gas barrier and gas inlet valves M12 x 1,5 and M18 x 1,5

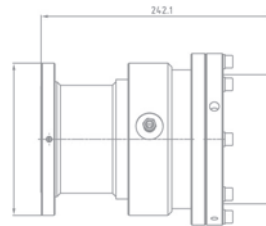

Cable Connectors, Clamp, 339 IEC 50-155 (EIA 6 1/8")

TYPE	CEL 50-155-703
CODE	74745
WEIGHT	15.900 g
CABLE TYPE	HELIFLEX HCA 495-50
REMARK	Inner conductor added. Connector with gas barrier and gas inlet valves M12 x 1,5 and M18 x 1,5

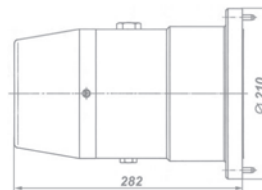

TYPE	CEL 50-155-709
CODE	82495
WEIGHT	17.500 g
CABLE TYPE	HELIFLEX HCA 550-50
REMARK	Inner conductor added. Connector with gas barrier and gas inlet valves M12 x 1,5 and M18 x 1,5



TYPE	CEL 50-155-712
CODE	66447
WEIGHT	19.800 g
CABLE TYPE	HELIFLEX HCA 618-50
REMARK	Inner conductor added. Connector with gas barrier and gas inlet valves M12 x 1,5 and M18 x 1,5

